

# Fort Doors

## Side Hinged Framed Fitting Instructions v4.0

### • Contents –

- 6 Angled frame fixing brackets
- 1 x handle pack
- 12 x self drilling tech screws
- 3 Keys
- 1x door
- 12 x 50mm coach screws .
  
- This door is CE Marked and comes with a Europe wide 2 year warranty , the warranty is subject to conditions please see your dealer or visit [www.FortDoors.co.uk](http://www.FortDoors.co.uk) for terms .
- **Fixings not supplied**
- We recommend 8mm wall plugs (Rawl)
- Silicone sealer
- Light Oil (3in1)

### • Before you start !!

- Caution Garage doors Are heavy and we recommend that this item be installed by two persons
- Do not allow children to assist in the installation of this product or use the product un-assisted , garage doors can inflict severe injury if not used or fitted correctly .

### **Measure**

Check measure the door and frame against the brick opening to ensure the door will open when installed , If fitting behind the opening ensure the door will open without fouling the brickwork .

### **Tools required**



This door is CE Marked and comes with a European 2 year warranty , the warranty is subject to conditions please see your dealer or visit [www.fortdoors.co.uk](http://www.fortdoors.co.uk) for terms .

**I Need help ! Call 0121 749 3699 .**

# Installation

Offer door up to brickwork and level using wedges .

Check with spirit level

Check for suitable fixing point and attach 1 x Angled frame fixing bracket to the back of the door frame using 2 x self drilling tech screws , repeat the process so you have at least 3 brackets per side evenly spaced, out pictured below is an example .

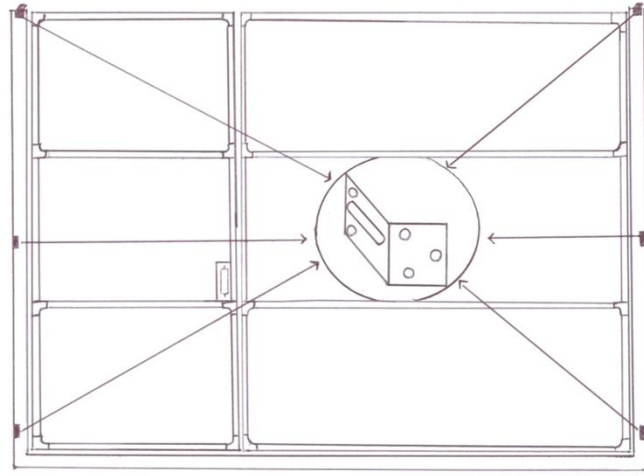

Now bolt the brackets to the wall with 2 x 50mm coach screws you will need Rawl plugs (not supplied) at this stage . Ensure the brackets are firmly fixed in place and the door is rigid

Before fully tightening the screws check the two doors meet correctly across the top and are level adjust the legs in/ outwards to ensure a good overall appearance .

Spray oil the hinges and latching plates /lock to ensure a smooth operation .

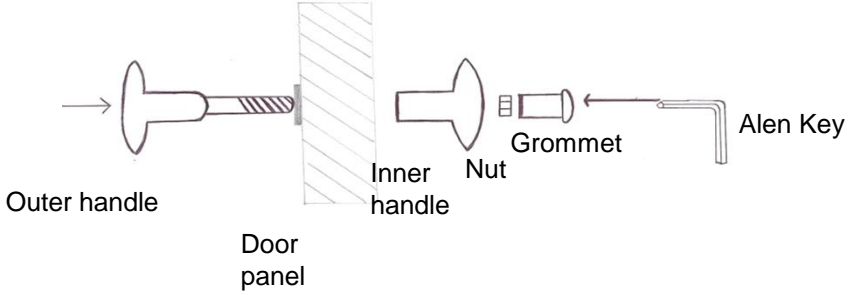

Push the outer handle with the spindle through the door panel ,push the inner handle over the spindle , the nut goes on next followed by the grommet ( the grommet goes over the nut and you tighten with an Allen key . Do Not Overtighten as this can crush the outer panel . Check the locking works correctly from the **inside** by closing the door and opening again , do not do this from the outside as if adjustment is required you may not be able to open the door again . Finish the door with trim and remove any protective film from the face of the door .

Never check that the locking works from outside ! Always have a person inside as you may lock yourself out resulting in serious damage to the door if you have to force entry .

**I Need Help !0121 7493699 M-F 8.30 – 5pm .**

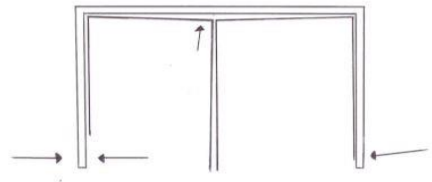

**Side hinged Adjustment .**  
 A common problem when fitting a side hinged garage door is levelling the two leaves correctly , most people fit to either brick or a timber sub frame and working from a spirit level they often think that this is perfect only to find the top of the doors do not align and automatically think a manufacturing fault is to blame .

Firstly it is important to know that all side hinged doors are hand made and as such each half can have minor differences in size , this is an industry wide accepted build method due to the nature of the product , you should adjust the legs to give the best appearance in all cases .

Problem 1 , Both of my doors are fitted with a slope across the top ( as pictured ) . Move both legs inwards to lift the center line up , only a fraction of movement at the bottom either in or out is required to obtain the best appearance, **Tip !** it is best to put temporary packers between the brick or timber until you are happy , this will mean less drilling of holes whilst you adjust, leave the top fixing in place to stop the doors falling out of the hole .

Problem 2, One of my leaves looks fine the other slanted. As above move the leg of the door that looks slanted inwards this will raise the slanted side upwards to align correctly .

Problem 3, My doors look terrible they are both out of line with one looking higher than the other ! Have you fitted to the floor level rather than the door level i.e is one leg higher than the other resulting in the poor appearance , using small packers lift the the lower leg and adjust as described above to obtain the best overall appearance .

I still cant make it look good ! Call an experienced fitter from your yellow pages to adjust the door for you or call the factory for an approved installer (charges will apply ) .